

Getting a new home connected with fibre through OPENetworks

Step 1.

Does your home have equipment like [picture 1](#) in a cabinet or otherwise? If so you have the required setup already installed and you can order an internet service here. If that is not the case, or you are not sure please click step 2.

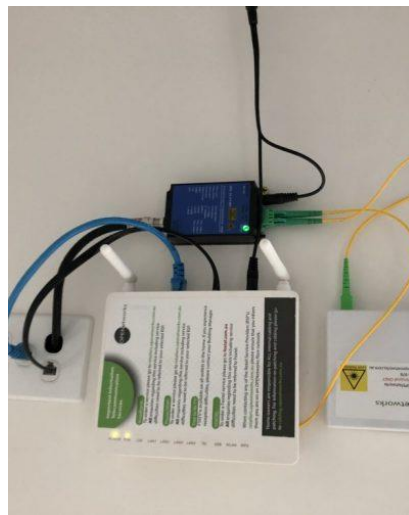

1. OPENetworks Fibre equipment

Step 2.

What OPENetworks needs before we can install fibre equipment:

- A Communication Cabinet is needed. Inside, a double power point is required. The voice and data cabling from within the home should terminate in RJ45 outlets in the enclosure. The cabinet must be at least 380mm height by 380mm width by 95mm depth (380h x 380w x 95d)mm. [SEE PICTURE 2](#)
- A Junction box connecting the outside lead in conduit to the internal home conduit will be required. The draw strings to both conduits need to be available. [SEE PICTURE 2](#)
- A minimum of P20 lead in conduit is needed to connect the cabinet and junction box to the pit in the street. Drawstrings are required all the way through. Sweep bends needed and the conduit must be clear and free to haul through fibre cable.

OPENetworks Pty Ltd

ACN 118 525 821

W www.openetworks.com.au

A Level 2, Oxley House
20 Hockings Street
West End QLD 4101

E info@openetworks.com.au

P PO Box 717
Indooroopilly
QLD 4068

T +61 7 3171 2222

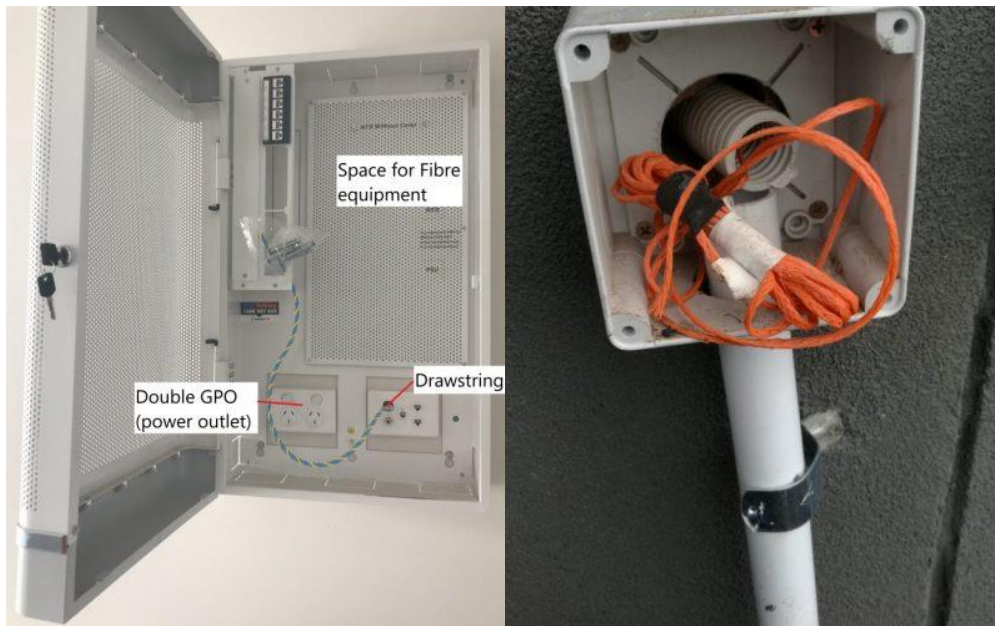

2. Required cabinet setup and Junction box setup w/ drawstrings

Step 3:

Get your electrician to complete any work detailed in step 2. Once your network infrastructure looks like the example pictures 2 and 3 you can order a service through one of our Retail service providers.

Step 4:

Send pictures of your completed setup to info@opennetworks.com.au or via our contact us form at the bottom of this page. The photos should be of high quality and depict exactly what the example photos show on this page.

OPENetworks Pty Ltd

ACN 118 525 821

W www.opennetworks.com.au

A Level 2, Oxley House
20 Hockings Street
West End QLD 4101

E info@opennetworks.com.au

P PO Box 717
Indooroopilly
QLD 4068

T +61 7 3171 2222